

# VIŠESTAMBENA ZGRADA U MANDRAMA, STAN S1

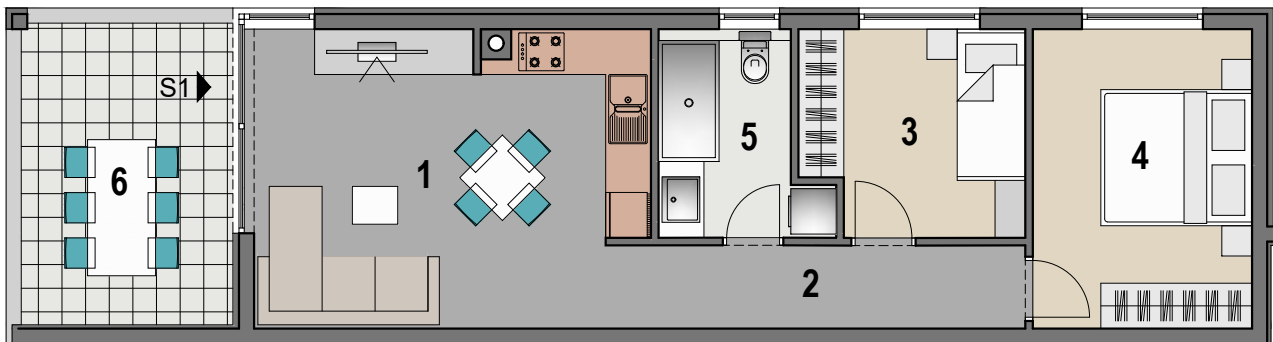

PRIZEMLJE M 1:100

STAN S1		
1	DNEVNI BORAVAK I KUHINJA	19.80 m <sup>2</sup>
2	HODNIK	6.10 m <sup>2</sup>
3	SOBA 1	7.80 m <sup>2</sup>
4	SOBA 2	11.50 m <sup>2</sup>
5	KUPAONICA	5.00 m <sup>2</sup>
6	NATKRIVENA TERASA	11.40 m <sup>2</sup>
		<b>61.60 m<sup>2</sup></b>