

# VIŠESTAMBENA ZGRADA U MANDRAMA, STAN S10

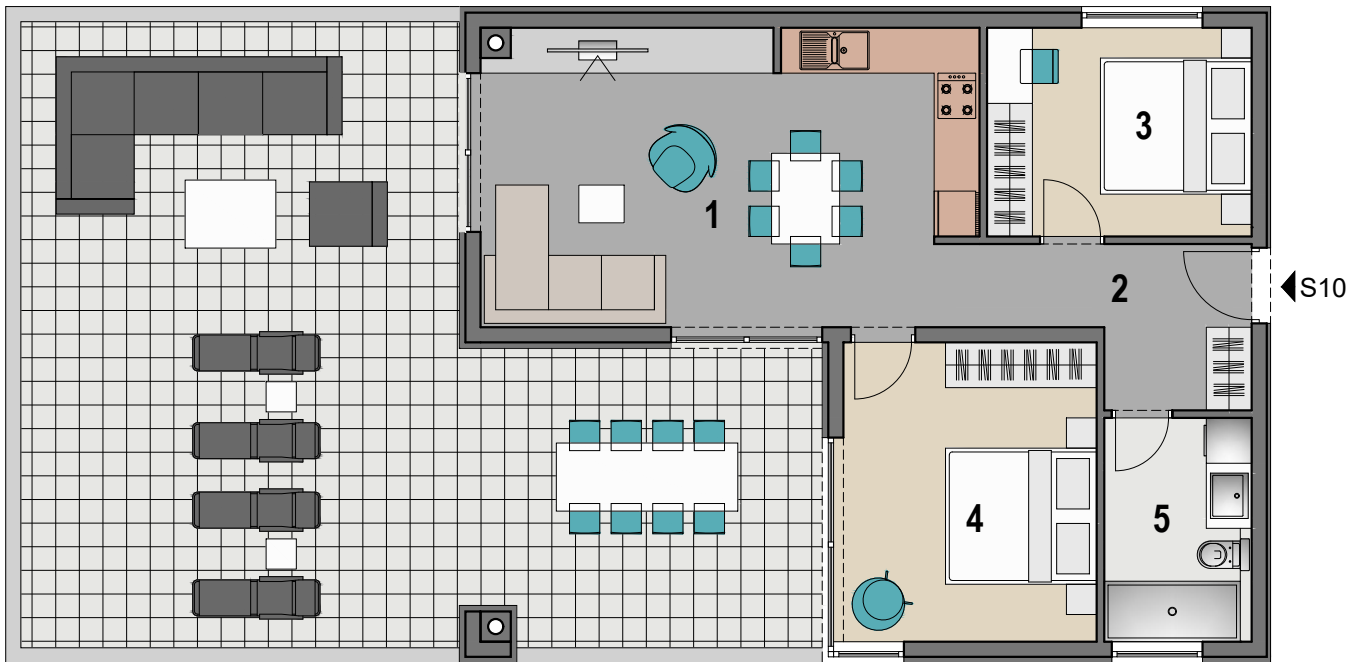

POTKROVLJE M 1:100

| STAN S10 |                          |                             |
|----------|--------------------------|-----------------------------|
| 1        | DNEVNI BORAVAK I KUHINJA | 25.20 m <sup>2</sup>        |
| 2        | HODNIK                   | 6.10 m <sup>2</sup>         |
| 3        | SOBA 1                   | 9.70 m <sup>2</sup>         |
| 4        | SOBA 2                   | 13.30 m <sup>2</sup>        |
| 5        | KUPAONICA                | 5.50 m <sup>2</sup>         |
| 6        | NATKRIVENA TERASA        | 18.60 m <sup>2</sup>        |
| 7        | NENATKRIVENA TERASA      | 48.00 m <sup>2</sup>        |
|          |                          | <b>126.40 m<sup>2</sup></b> |