

VIŠESTAMBENA ZGRADA U MANDRAMA, STAN S4

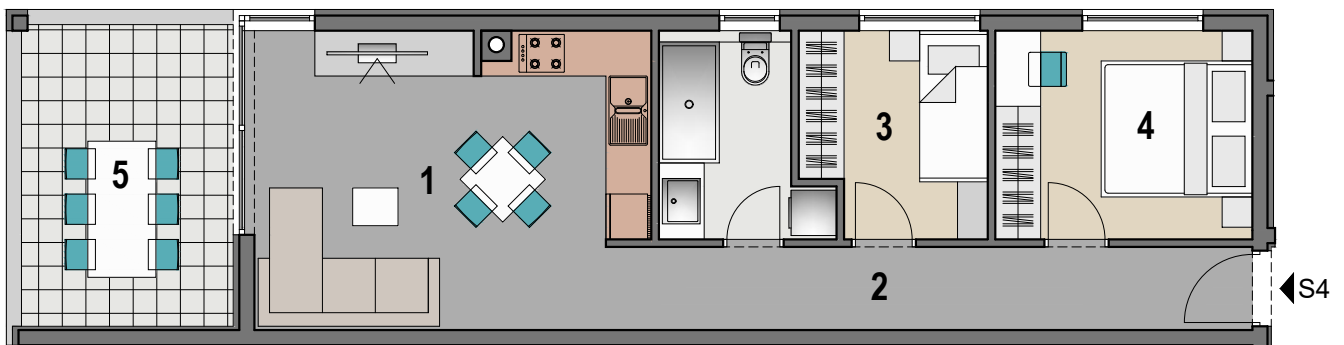

1. KAT M 1:100

STAN S4		
1	DNEVNI BORAVAK I KUHINJA	19.80 m ²
2	HODNIK	9.40 m ²
3	SOBA 1	6.40 m ²
4	SOBA 2	9.40 m ²
5	KUPAONICA	5.00 m ²
6	NATKRIVENA TERASA	11.10 m ²
		61.10 m²